



321A Hector Street Tuart Hill WA

3  2  2 

Positioned in a sought-after city-fringe pocket, 321A Hector Street, Tuart Hill is a standout residence that delivers the perfect balance of space, style and low-maintenance living.

Built to an above-average scale and set on approximately 279sqm with 178sqm under the main roof, this quality home stands out with its expansive layout and functional design.

From the moment you arrive, the attractive street presence sets the tone. Step inside and you're welcomed by a light-filled, thoughtfully designed floorplan that maximises natural light and functionality.

[For full version visit the website](https://www.abelproperty.com.au/86923)

Type : House
Price : Offers - Contact Agent
Building Size : 178 sqm
Land Size : 279 sqm
View : <https://www.abelproperty.com.au/86923>
61



Dominic Ferraro
08 9208 1999

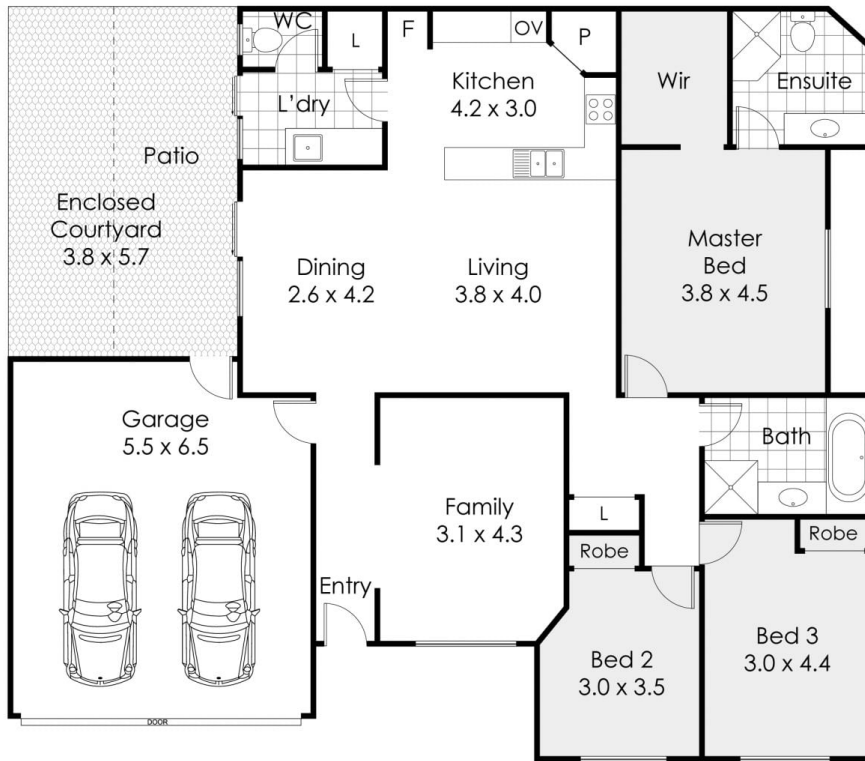

321a Hector Street, Tuart Hill

This floor plan is not to scale.
 Dimensions are approximate and therefore should only be used for illustrative purposes.

	196 m ²
	3 Bed
	2 Bath
	2 Car

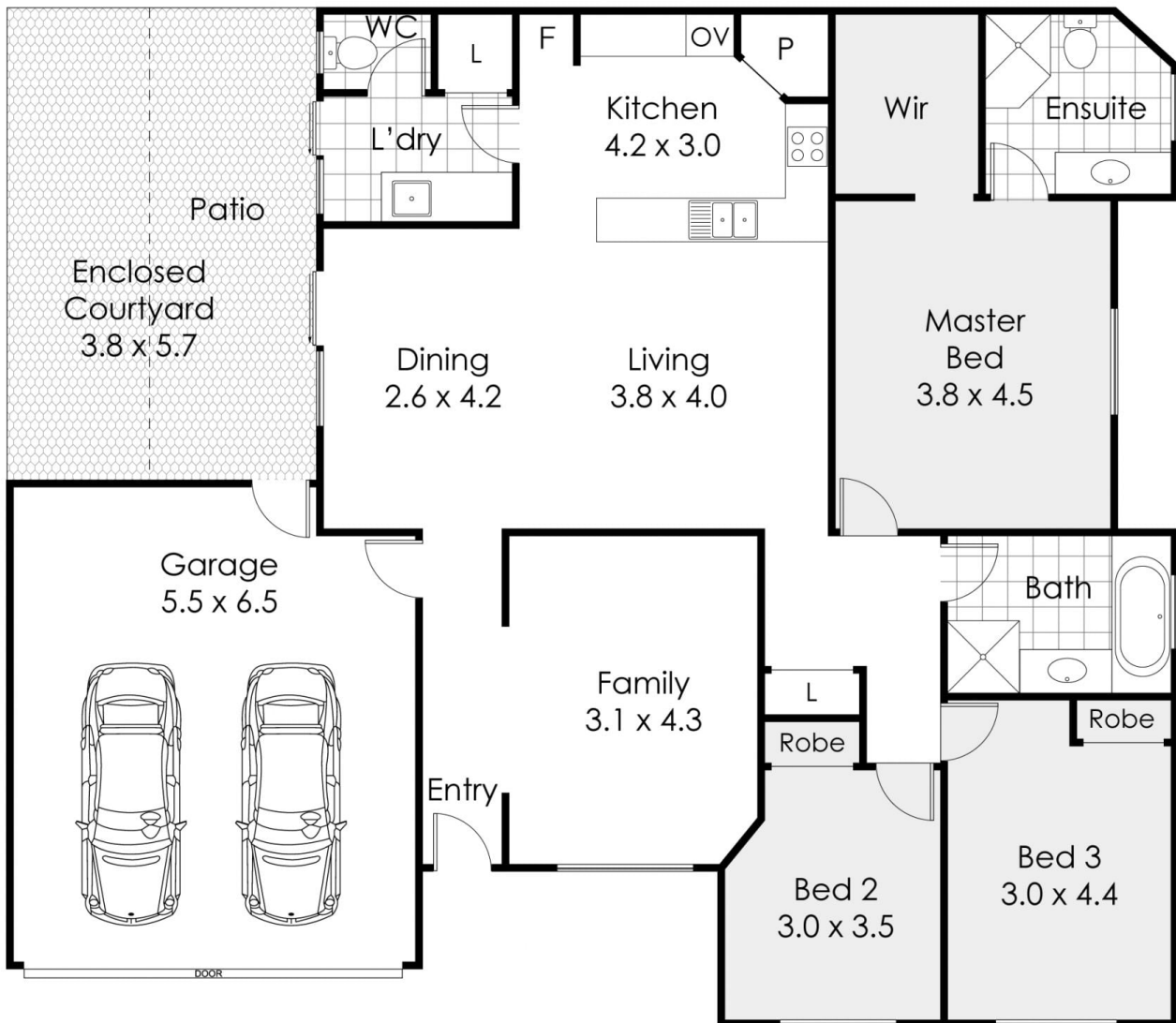

321 a Hector Street, Tuart Hill

This floor plan is not to scale.
 Dimensions are approximate and therefore should only be used for illustrative purposes.

-  196 m²
-  3 Bed
-  2 Bath
-  2 Car