

69/308-318 Great Eastern Highway Ascot WA

2 2 2

First Home Open Saturday 23 November 10:45 to 11:30 AM.

This modern, freshly painted and beautifully maintained duplex-style townhouse awaits, offering two bedrooms, a powder room, two bathrooms, two outdoor areas, storeroom and parking for two cars.

North facing and offering terrific natural light throughout, the home is ideally positioned in a quiet corner of the complex with the occasional 'neighing of neighbours' from the nearby stables.

Both bedrooms are a great size and both have large built-in robes, air conditioners, quality carpets and great natural

**Type** : Townhouse  
**Building Size** : 151 sqm  
**View** : <https://www.abelproperty.com.au/81862>  
40



**Kyle Peters**  
08 9208 1999

[For full version visit the website](https://www.abelproperty.com.au)

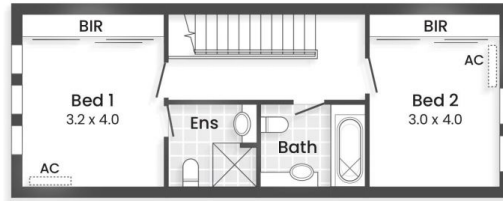

FIRST FLOOR

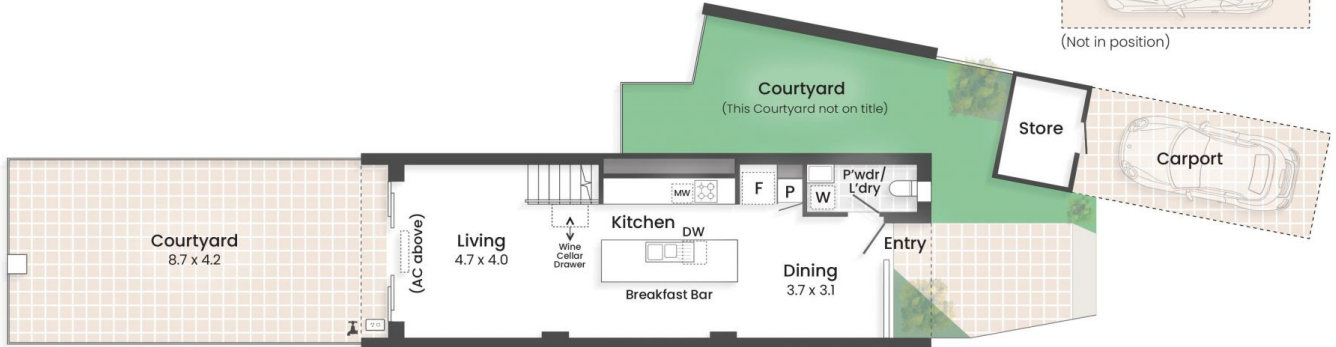

GROUND FLOOR

Strata Areas	
Ground Floor	44m <sup>2</sup>
First Floor	40m <sup>2</sup>
Rear Courtyard	37m <sup>2</sup>
Storeroom	3m <sup>2</sup>
Carport	13m <sup>2</sup>
2nd Car Bay	14m <sup>2</sup>
<b>Total</b>	<b>151m<sup>2</sup></b>

69/308 Great Eastern Hwy ASCOT

Dimensions and Areas are approximate. Drawn for presentation puposes only.

info@openpad.com.au @openpad