



18/228 West Coast Highway Scarborough WA

2  1  1 

Welcome to this two-bedroom villa, perfectly situated in the heart of Scarborough, just steps from the stunning beach and vibrant esplanade. Experience the best of coastal living with cafés, restaurants, and recreational activities right at your doorstep, allowing you to fully embrace the beach lifestyle

This property is located in a rezoned area with an R160 Mixed Use designation, opening up exciting future possibilities for holiday accommodations or apartment developments within the MRA redevelopment zone

As you step into the welcoming front courtyard, you'll find an inviting space ideal for morning coffee or relaxation, setting a warm tone for the home. Inside, enjoy a cozy

Type : Unit
Price : UNDER OFFER!
View : <https://www.abelproperty.com.au/8168906>



Deirdre McTiernan
08 9208 1999

[For full version visit the website](https://www.abelproperty.com.au)

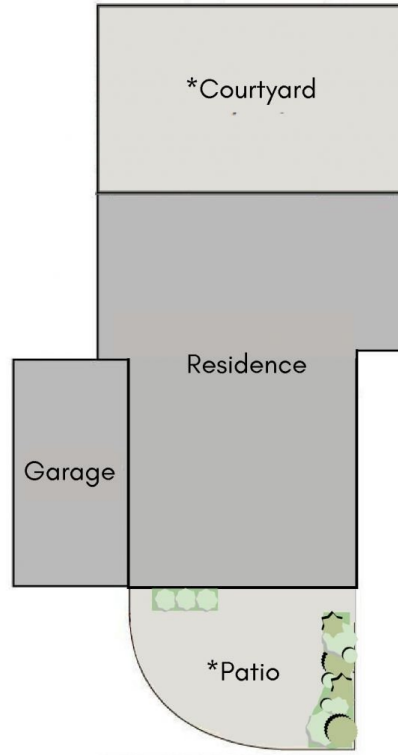
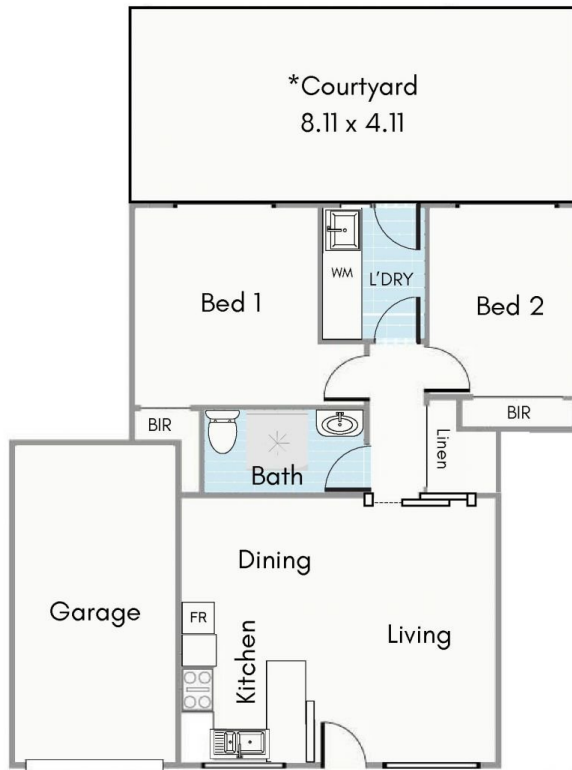

18/228 West Coast Highway Scarborough
 Unit 67m² | Garage 15m² | *Courtyard 33.33m² | *Patio 8.5m²
Approx Total Area 123.83m²
***Approx Total Exclusive Area 41.83m²**

***For Exclusive Use**



The floorplan is for illustration purposes only to show the layout of the property. While every effort has been made to ensure the accuracy of the floor plan, all measurements and any other information shown is an approximate representation only. Measurements and total areas do not or cannot be assured for wall thickness or roof area under eaves, no liability or responsibility for any errors, omissions, misrepresentation or use of any information shown on the floor plan. Not to be used for any other purpose.